

4

3

2

1

D

C

B

A

D

C

B

A

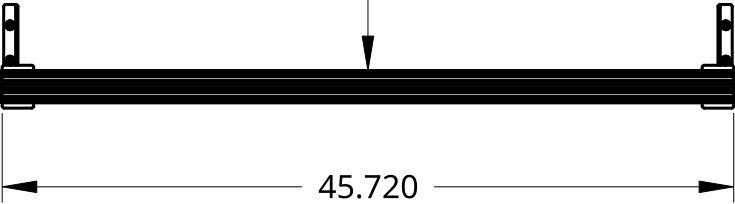
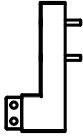
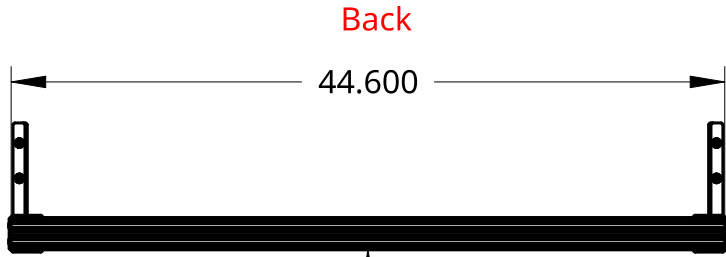

47.126

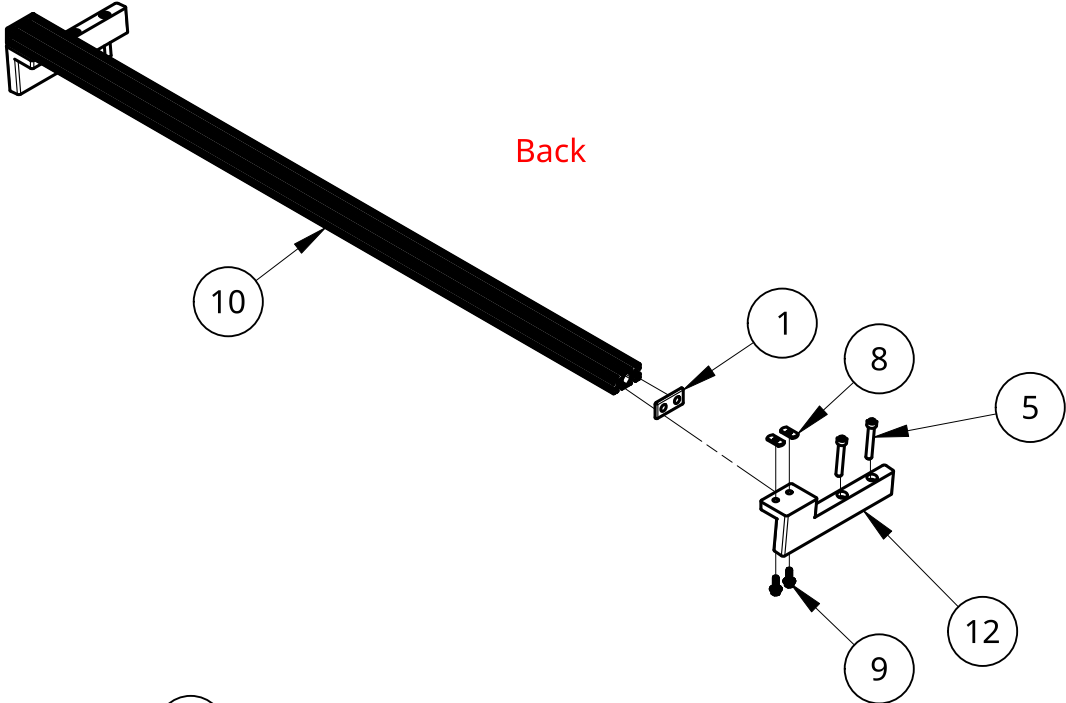
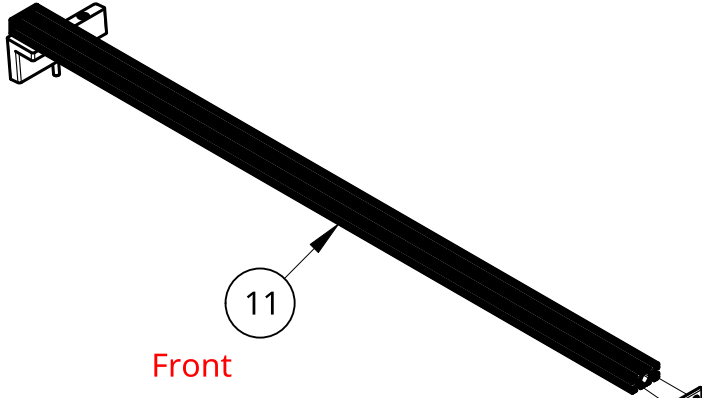
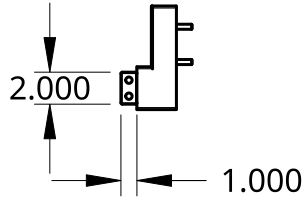

Item	Quantity	Name	Part number	Description
1	4	End Cap	3136N22	T-Slotted Framing, End Cap for 2" High Double Rail Black
2	1	01-0420-01.001	01-0120-01.101	Machined aluminum, black
3	4	Flanged Bolt	ABABA-25C75BWFS	1/4-20 X 3/4 WHIZ FLNG BLT S/S
4	4	T-Slot Nut	ABABA-8020-3382	1/4-20 10 S ECONOMY T-SLOT NUT, END FEED SINGLE (BLK)
5	8	Hex socket head cap screw M8x1.25 x 55	ABABA-.8C55KCSS	Hex socket head cap screw M8x1.25 x 55 Stainless Steel
6	1	01-0420-01.002	01-0120-01.101	Machined aluminum, black
7	1	01-0420-01.003	01-0120-01.101	Machined aluminum, black
8	4	T-Slot Nut	ABABA-8020-3382	1/4-20 10 S ECONOMY T-SLOT NUT, END FEED SINGLE (BLK)
9	4	Flanged Bolt	ABABA-25C75BWFS	1/4-20 X 3/4 WHIZ FLNG BLT S/S
10	1	Crossbar - Back	47065T124	44.60" FRAME, T-SLOT, 1 X 2, ALUM_BACK
11	1	Crossbar - Front	47065T124	45.720" FRAME, T-SLOT, 1 X 2, ALUM_BACK
12	1	01-0420-01.004	01-0120-01.101	Machined aluminum, black

UNLESS OTHERWISE SPECIFIED, DIMENSIONS ARE IN INCHES .XX = ±.0- .XXX = ±.00- .XXXX = ±.000- SURFACE FINISH ✓ DO NOT SCALE DRAWING BREAK ALL SHARP EDGES AND REMOVE BURRS THIRD ANGLE PROJECTION		DRAWN	NAME	DATE	TITLE 4Runner Cross Bars Low Mount Roof Rack Tent Crossbar Kit	
		CHECKED	Justus Standley	03/29/2021		
		APPROVED				
		MATERIAL	FINISH		SIZE B	DWG NO. 2601-0100
					SCALE 1:12	REV. V4
					WEIGHT	SHEET 1 of 1

4

3

2

1

D

D

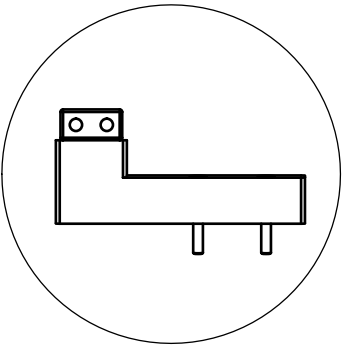

(Rear Mount)

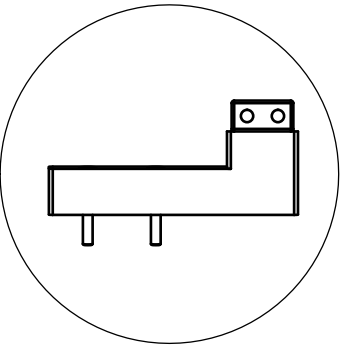
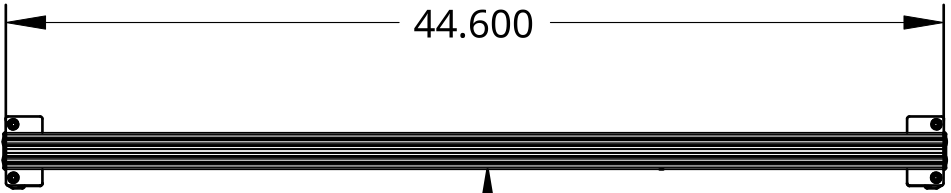

(Rear Mount)

C

C

Passenger Side

Driver Side

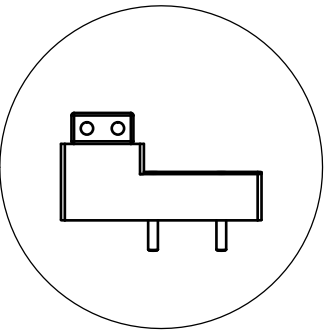

(Front Mount)

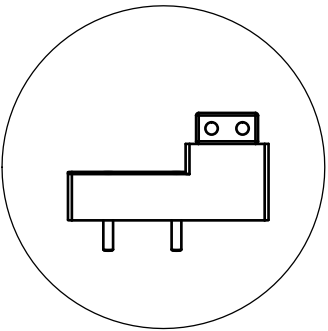
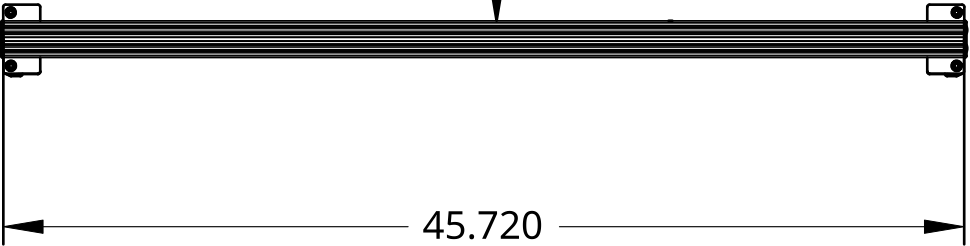

(Front Mount)

B

B

A

A

Rear

Front

44.600

47.126

45.720



UNLESS OTHERWISE SPECIFIED, DIMENSIONS ARE IN INCHES .XX = ±.0- .XXX = ±.00- .XXXX = ±.000-		NAME Justus Standley	DATE 11/15/2021		
SURFACE FINISH ✓		CHECKED		TITLE 4Runner Cross Bars Low Mount Roof Rack Tent Crossbar Kit	
DO NOT SCALE DRAWING		APPROVED			
BREAK ALL SHARP EDGES AND REMOVE BURRS				SIZE B	DWG NO. 2601-0100
THIRD ANGLE PROJECTION 		MATERIAL	FINISH	SCALE 1:12	WEIGHT
				SHEET 1 of 2	REV. V1

- 4
- 3
- 2
- 1
- D
- C
- B
- A
- 1) Remove OEM crossbars and all mounting hardware along with the rubber dust cover that lives in the top edge channels from the back.
- 2) Mount the BA Mounting standoffs as shown using supplied hardware.
- 3) Replace the rubber dust cover and trim to meet up to the standoffs.
- 4) Attach Cross bars as shown using the 1/4"-20 T-nuts and 3/4" serated flange bolts.
- 5) Deploy the tent on saw horses and then carefully lift above the vehicle and set on the frame.
- 6) Locate the t-nuts already in the bottom edge of the frame and place in a position where you can mount them to the 8x angle brackets, **shown in red**, below.
- 7) Center the frame side to side on the crossbars and the back will be **9" from the back edge of the crossbar to the back edge of the tent frame**.
- 8) Attached all 8x angle brackets with supplied hardware and tighten.
- 9) Close then and you're off to your next adventure!

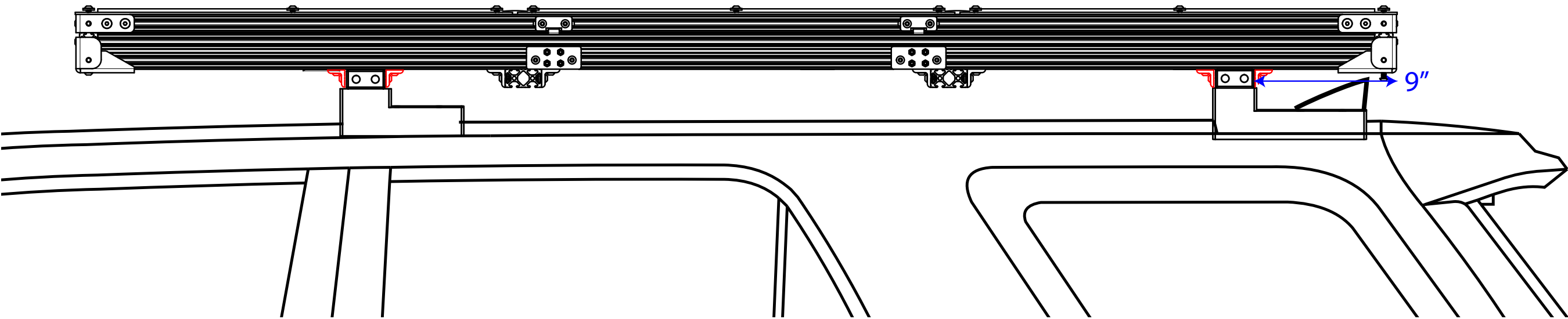

We suggest watching this open/close video to help you master the technique. <https://youtu.be/Sj7Ebep-mB8>



UNLESS OTHERWISE SPECIFIED, DIMENSIONS ARE IN INCHES .XX = ±.0- .XXX = ±.00- .XXXX = ±.000- SURFACE FINISH ✓ DO NOT SCALE DRAWING BREAK ALL SHARP EDGES AND REMOVE BURRS THIRD ANGLE PROJECTION		NAME Justus Standley	DATE 11/15/2021	BA TENTS	
		DRAWN		TITLE	
		CHECKED			
		APPROVED			
		MATERIAL	FINISH	SIZE B	DWG NO. 2602-0100
				SCALE 1:12	REV. V1
				WEIGHT	SHEET 1 of 2